



# 26.901.162 (Turbo)

## High Performance Adjustable Spray Gun

UDOR High Performance Spray Guns have a spray pattern that is adjustable from a concentrated 0° straight stream to a 60° fine mist cone.

They are an excellent choice for a wide variety of applications including tree & shrub spraying, pest control, greenhouse & nursery and equipment cleaning.

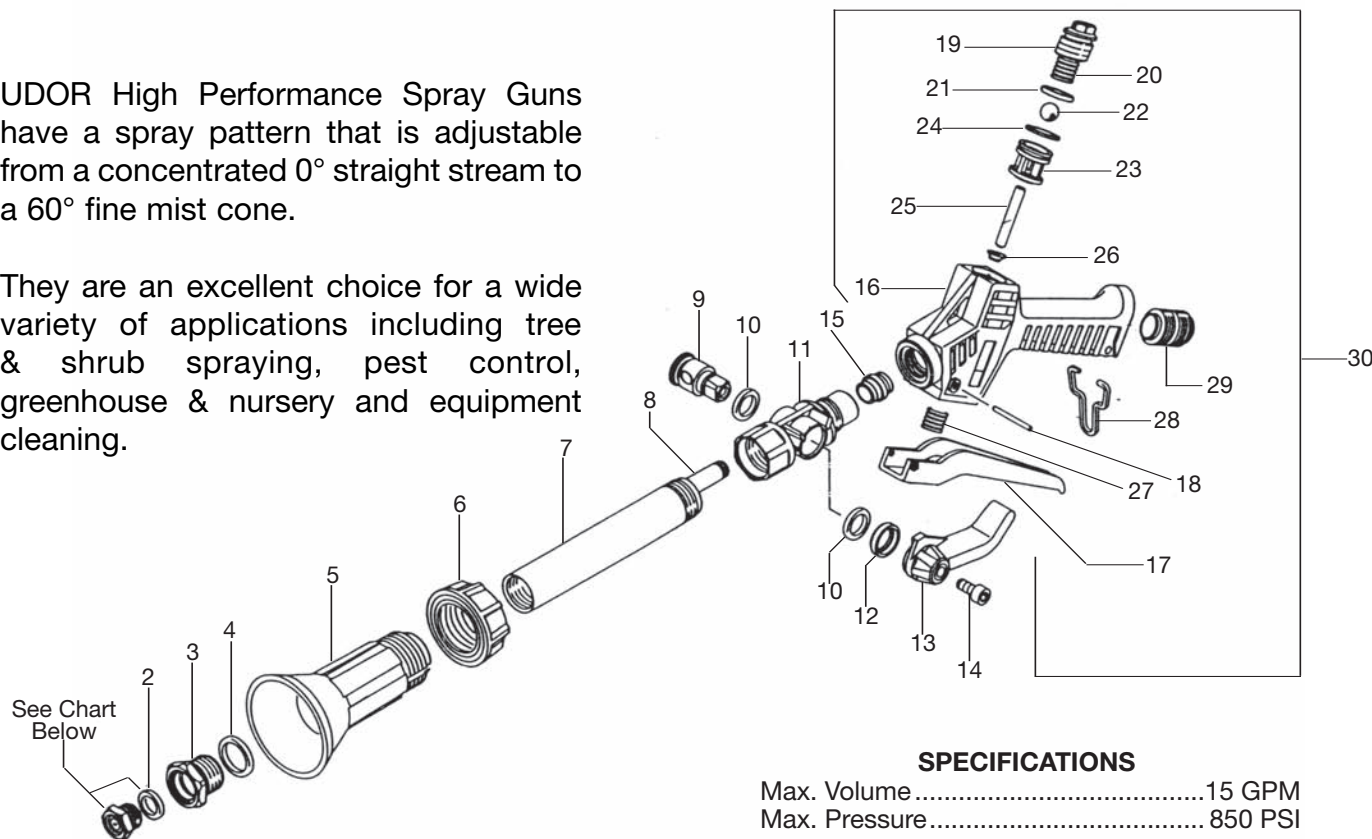

### SPECIFICATIONS

Max. Volume.....15 GPM  
Max. Pressure..... 850 PSI

REF#	PART#	DESCRIPTION	QTY	REF#	PART#	DESCRIPTION	QTY
1	See Chart	Spray Tip	1	16	01-29.208.131	Gun Handle	1
2	01-7.602.1	O-Ring	1	17	01-29.902.8	Trigger	1
3	01-26.1701.10	Nozzle Retainer	1	18	01-29.1607.3	Trigger Pin	1
4	01-68.602.10	O-Ring	1	19	01-29.1702.26	Plug	1
5	01-26.1707.2	Nozzle Protector	1	*20	01-29.1003.24	Spring	1
6	01-26.605.50	Nut	1	*21	01-23.602.37	O-Ring	1
7	01-26.1703.22	Outer Tube	1	*22	01-29.1604.2	Ball	1
8	01-26.1705.55	Inner Tube	1	*23	01-23.1603.14	Seat	1
9	01-26.1304.33	Regulator	1	*24	01-23.602.36	O-Ring	1
*10	01-71.602.6	O-Ring	2	25	01-23.1304.29	Plunger	1
11	01-26.305.3	Body	1	*26	01-23.601.35	Seal	1
12	01-26.1506.14	Spacer	1	27	01-23.1003.16	Spring	1
13	01-26.902.6	Adjustment Lever	1	28	01-29.507.10	Trigger clip	1
14	01-26.1902.20	Bolt	1	29	01-29.1101.1	Inlet Adapter	1
15	01-26.801.5	Insert Guide	1	30	01.29.1903.7	Trigger Gun	1

\* Parts Included in Repair Kit #8711.03.

### SPRAY TIP PERFORMANCE CHART (High Performance Spray Guns) - Gallons Per Minute / Maximum Throw in Feet

PART #	Orifice (mm)	Material	100 PSI	200 PSI	400 PSI	600 PSI	800 PSI
68.1802.54	2.3	Ceramic	2.0 / 24	2.5 / 29	4.0 / 34	5.0 / 42	5.5 / 45
68.1802.16	2.5	Ceramic	2.5 / 23	3.0 / 28	4.5 / 32	5.5 / 40	6.5 / 44
68.1802.17	3.0	Ceramic	3.0 / 28	4.5 / 29	6.5 / 34	8.0 / 41	9.0 / 4
13.1802.73	3.5	S/S	4.5 / 31	6.0 / 36	8.5 / 41	11.0 / 50	12.0 / 54
13.1802.58	4.0	S/S	5.0 / 35	7.5 / 38	10.0 / 43	13.5 / 53	14.5 / 59
13.1802.59	4.5	S/S	6.5 / 37	9.0 / 39	12.5 / 44	16.5 / 54	18.0 / 62
13.1802.60	5.0	S/S	7.5 / 33	10.0 / 41	14.0 / 47	18.5 / 59	21.0 / 67
13.1802.61	5.5	S/S	8.0 / 35	11.5 / 42	16.0 / 47	21.0 / 59	23.0 / 70
13.1802.75	6.0	S/S	9.0 / 38	12.5 / 44	18.0 / 54	23.0 / 66	26.0 / 74
13.1802.74	7.0	S/S	9.5 / 21	13.5 / 47	19.0 / 57	24.0 / 70	27.0 / 77

26.901.162